

222 Miles

277 Miles

- Old Multimode Fiber that needs replaced
- Old Singlemode Fiber that needs replaced

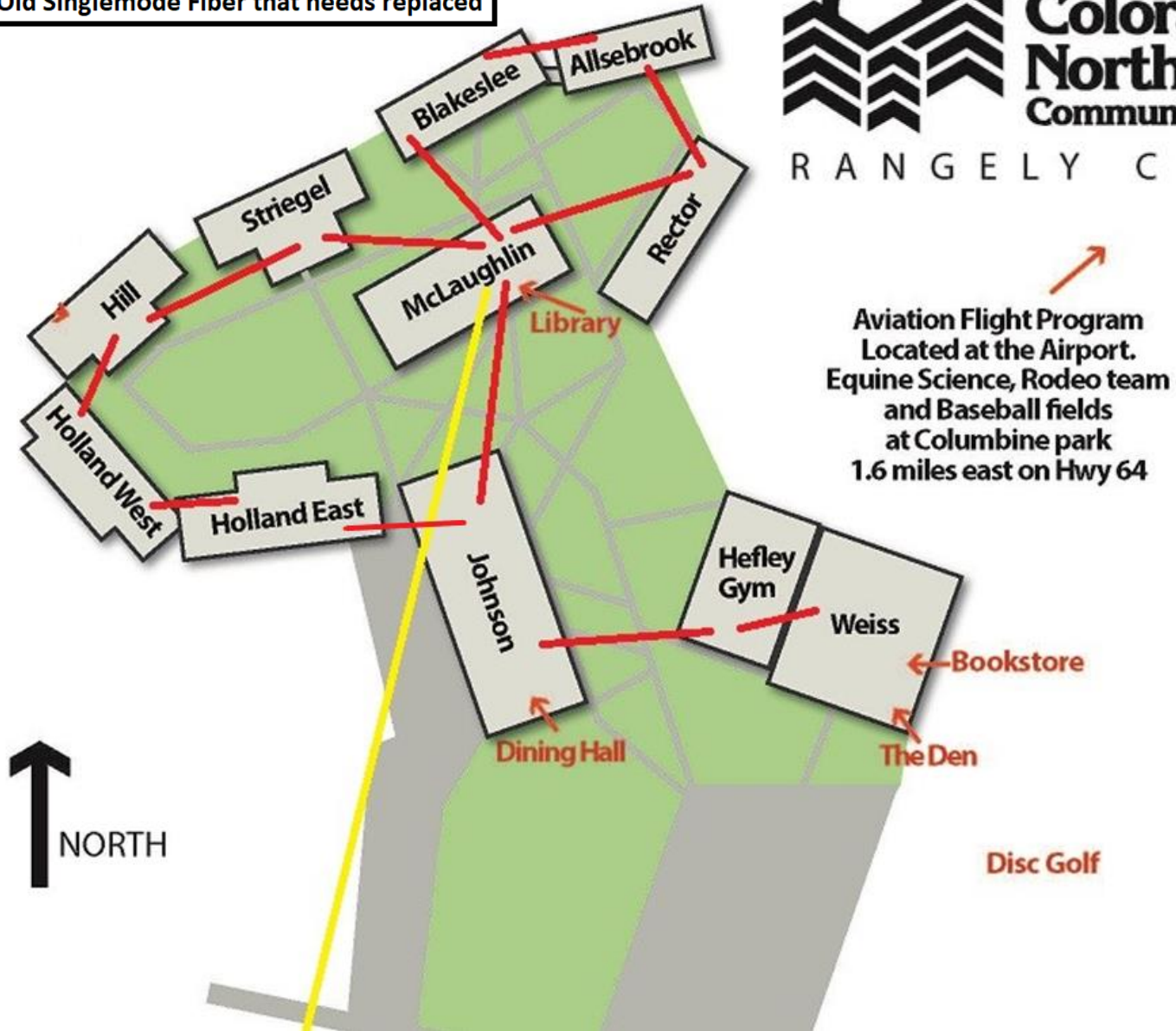

- Old Multimode Fiber that needs replaced
- Old Singlemode Fiber that needs replaced

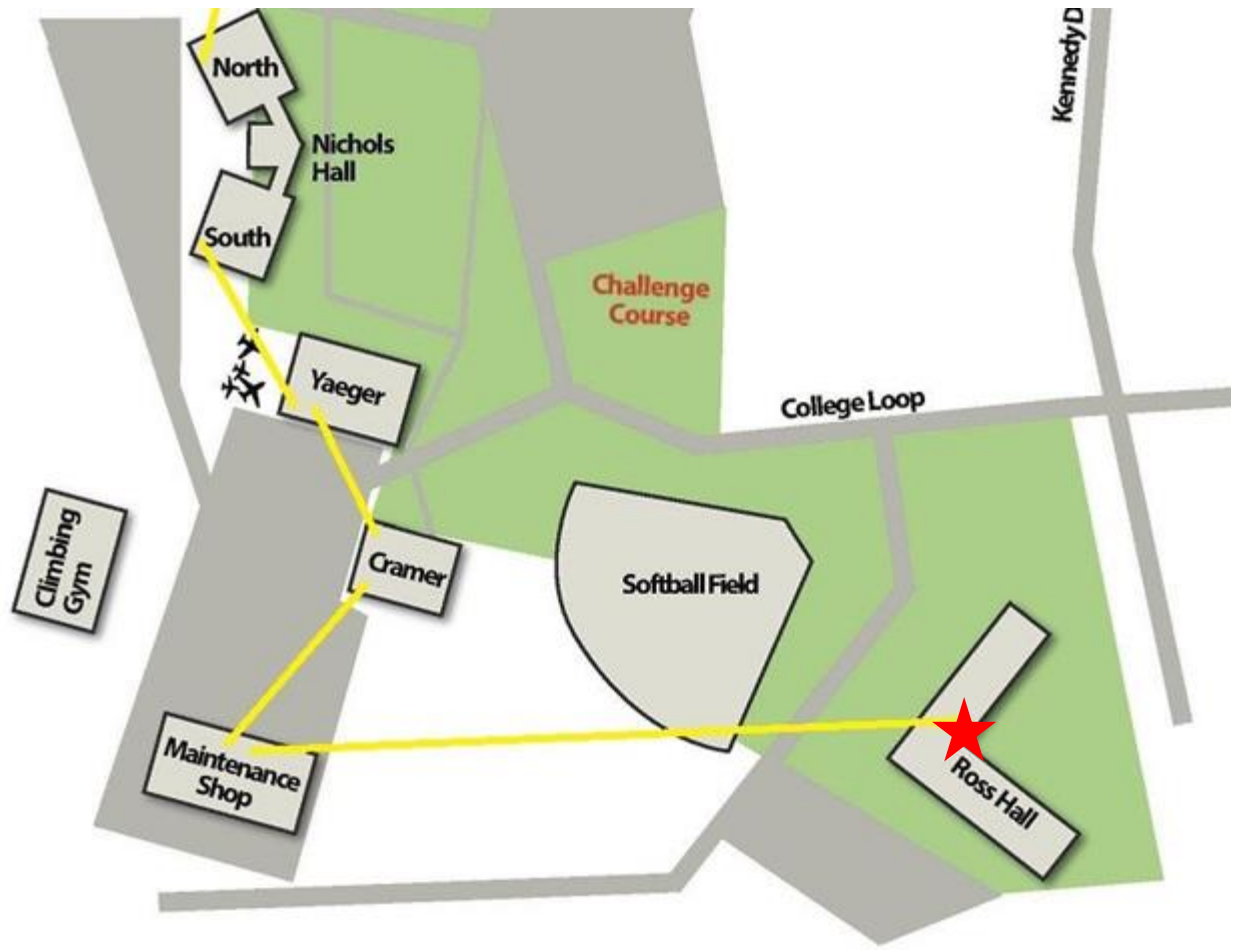

***Access point to Rio Blanco County Fiber for offsite data center and Airport network connection.**

- Old Multimode Fiber that needs replaced
- Old Singlemode Fiber that needs replaced

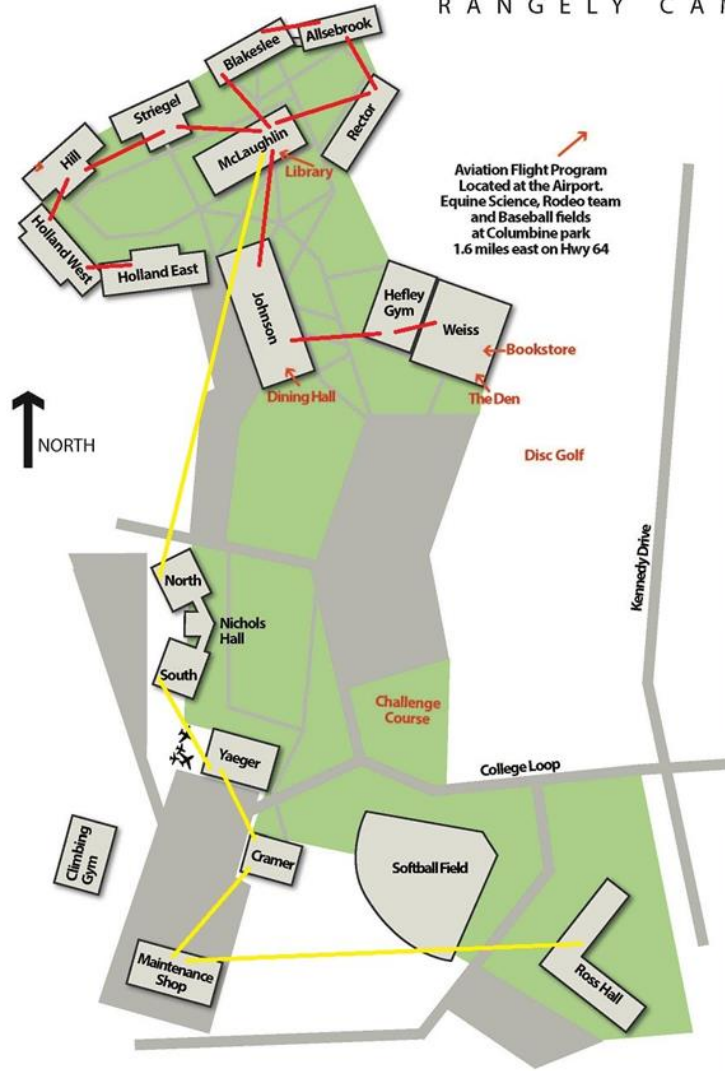

Aviation Flight Program
Located at the Airport.
Equine Science, Rodeo team
and Baseball fields
at Columbine park
1.6 miles east on Hwy 64

- Allsebrook**
Computer Labs
Classrooms
- Blakeslee**
Dental Hygiene
- Cramer**
Classrooms
- Hill**
Classrooms
- Johnson**
Community Education
Continuing Education
Dining Hall
Fine Arts
Student Services
Admissions
Cashier
Counseling
Financial Aid
Registrar
- McLaughlin**
Library (ground floor)
Administration
President
Business Offices
- Rector**
Science Labs
Classrooms
- Striegel**
Computer Lab
Classrooms
- Weiss**
Bookstore
The Den
Post Office
Weight & Cardio Rooms
Student Life
- Yaeger**
Aviation Maintenance